



UB-T-90 ◀ 110 cm ▶



#### Safety storage underbench cabinet

##### UB-T-90 model UB90.060.110.2T

in Light grey (RAL 7035), interior equipment with 1 x perforated insert, 1 x bottom collecting sump (sheet steel powder-coated)

Order No. 30443-001-33771 4



#### Safe and approved storage of flammable hazardous substances in working areas

##### Function / construction:

- **robust construction and longevity:** body made of powder-coated sheet steel
- **easy handling with comfort:** doors stop in any position, self-closing in the event of fire
- **user-friendly:** access to all containers, 135° opening of the wing door, interior of the cabinet completely visible
- **no unauthorised use:** doors lockable with cylinder lock and locking state indicator (red/green)
- **mobile:** castors with plinth (optionally available), easy moving of the cabinet
- **ventilation:** integrated air ducts ready for connection (DN 50) to a technical exhaust system

##### Available equipment

- shelves with load capacity of 75 kg
- perforated insert useable as storage area
- bottom collecting sump
- maximised interior height – ideal for the storage of 30 litre containers, convenient removal and storage of containers, problem-free connection of stored containers to supply and disposal pipes



#### Maximised interior height

High storage capacity – ideal for 30 litre containers  
problem-free connection to supply and disposal pipes

#### Recirculating air filter system

Avoid complex wall breakthroughs and expensive extraction piping.

Especially designed for the lower pressure conditions and volume flows of underbench cabinets.

Further information from page 395

Order No. 27144 2

(housing unit optional)



#### Technical data

		UB90.060.110.2T	UB90.060.110.050.2T
External dimensions W x D x H	mm	1102 x 574 x 600	1102 x 502 x 600
Internal dimensions W x D x H	mm	979 x 452 x 502	979 x 382 x 502
Weight without interior equip.	kg	180	160
Extraction air	DN	50	50
Air change <b>10 times</b>	m³/h	2	2
Diff. pressure (air change <b>10 times</b> )	Pa	1	1
Diff. pressure (air change <b>10 times</b> EK5/AK4)	Pa	1	1
Maximum load	kg	300	300
Distributed load	kg/m²	277.00	278.00

#### Usable storage heights

UB90.060.110(050).2T  
① mm 400\*

\* with perforated insert

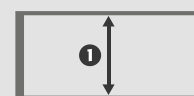



Front view

Side view

Top view

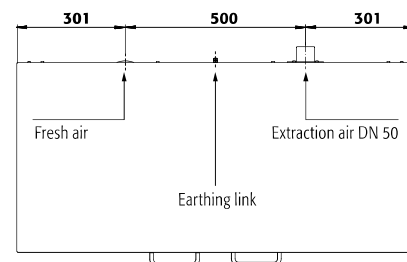
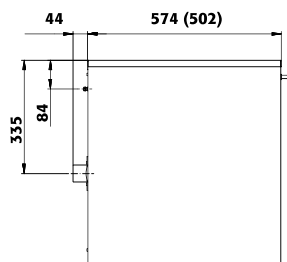
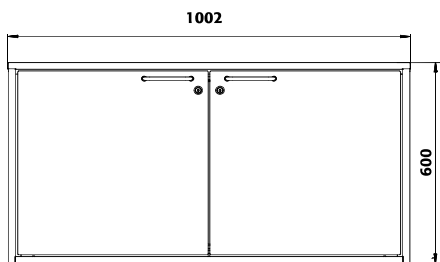

## Order example - how to order correctly



30443



001



33771



## Model

UB90.060.110.2T  
UB90.060.110.050.2T

## Information / equipment

without interior equipment, with 2 wing doors  
without interior equipment, with 2 wing doors

## Order No.

30443  
30444

## Body colour

Light grey RAL 7035

## Door colour

Light grey RAL 7035

## Order No.

001 4



## Depth 574 mm

## Interior equipment packages (can only be ordered in combination with the cabinet)

## Material

## Order No.

1x perforated insert, 1x bottom collecting sump (V=25.5L)  
 1x shelf, 1x perforated insert, 1x bottom collecting sump (V=25.5L)  
 left: 1x drawer (maximized internal height) (V=33.0L)  
 right: 1x drawer (maximized internal height) (V=33.0L)  
 1x perforated insert, 1x bottom collecting sump (V=22.0L)  
 1x shelf, 1x perforated insert, 1x bottom collecting sump (V=22.0L)

sheet steel powder-coated RAL 7035  
 sheet steel powder-coated RAL 7035  
 sheet steel powder-coated RAL 7035

old code new code  
 30447 33771 2  
 30448 33772 2  
 30449 30449 6

stainless steel  
 stainless steel

30450 30450 2  
 30451 30451 2



## Depth 502 mm

## Interior equipment packages (can only be ordered in combination with the cabinet)

## Material

## Order No.

1x perforated insert, 1x bottom collecting sump (V=22.5L)  
 1x shelf, 1x perforated insert, 1x bottom collecting sump (V=22.5L)

sheet steel powder-coated RAL 7035  
 sheet steel powder-coated RAL 7035

old code new code  
 30452 33775 2  
 30453 33776 2

Interior equipment  
Depth 574 mm

## Material

## W x D x H (mm)



1)

75.00

30454 2

30455 2

8374 2

8375 2

8372 2

8373 2

22 20

25.50 23.18

75.00

75.00

22.50 20.45

75.00

75.00

22.50 20.45

75.00

75.00

22.50 20.45

75.00

75.00

22.50 20.45

75.00

75.00

22.50 20.45

75.00

75.00

22.50 20.45

75.00

75.00

22.50 20.45

75.00

75.00

Interior equipment  
Depth 502 mm

## Material

## W x D x H (mm)



1)

75.00

30456 2

18813 2

18812 2

22.50 20.45

75.00

75.00

22.50 20.45

75.00

75.00

22.50 20.45

75.00

75.00

22.50 20.45

75.00

75.00

22.50 20.45

75.00

75.00

22.50 20.45

75.00

75.00

22.50 20.45

75.00

75.00

Interior equipment  
All models

## Material

## W x D x H (mm)

## Order No.

pipe lead-through  
 bottle rack, for 8 bottles with Ø 90 mm  
 bottle rack, for 15 bottles with Ø 70 mm  
 bottle rack, for 32 bottles with Ø 40 mm  
 castors with plinth, height = 30 mm

sheet steel powder-coated RAL 7035  
 sheet steel powder-coated RAL 7035  
 sheet steel powder-coated RAL 7035  
 sheet steel powder-coated RAL 7035  
 sheet steel powder-coated RAL 7035

182 x 104 x 48  
 220 x 440 x 30  
 220 x 440 x 30  
 220 x 440 x 30

30035 2  
 7604 2  
 7603 2  
 7602 2  
 30362 2



## Accessories

extraction module with exhaust air monitoring for wall mounting, for underbench cabinets  
 recirculating air filter system with exhaust air monitoring, for underbench cabinets  
 adapter, as separate housing unit for lateral mounting

## Order No.

24315 2  
 27144 2  
 26885 2

\* usable storage space W x D (mm)

1) load capacity (kg), 2) retention capacity (ltd), 3) maximum container volume in the cabinet (ltd)